

Mi Monogram Ind.

WHEN ORDERING PARTS ALWAYS STATE:

MODEL NO.: 152

PART NO.: _____ CATALOG RV-4-TTT (1)

DESCRIPTION: TOTA II PORTABLE TOILET

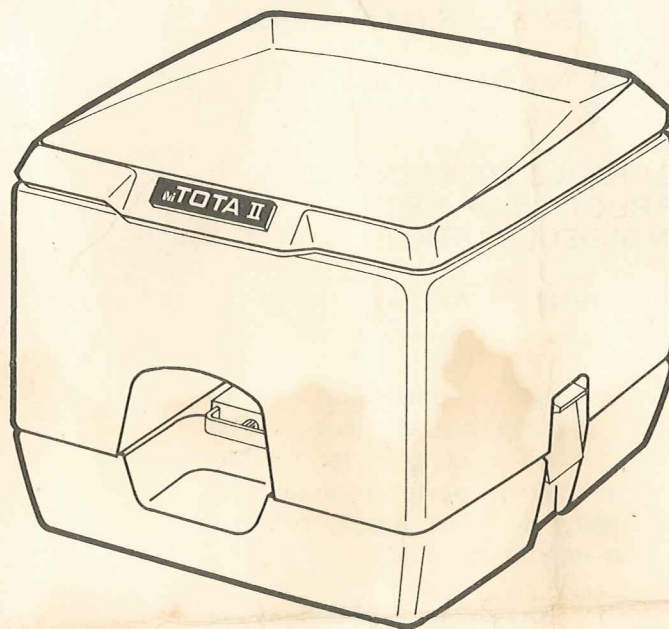

OPERATING INSTRUCTIONS AND
REPLACEMENT PARTS LIST

TOTA II™
PORTABLE
TOILET

NO. 152

RV-4-TTT (1)

1165 EAST 230TH STREET CARSON, CALIFORNIA 90745
2514 NAGY DRIVE, R.R. 3, BOX 12A, ELKHART, INDIANA 46514

TOTA II™

PORTABLE TOILET

FEATURES

- COMPLETELY SELF-CONTAINED.
- NO INSTALLATION OR ELECTRICITY REQUIRED.
- SEPARATE WASTE HOLDING TANK FOR EASY SEWAGE DISPOSAL.
- FRESH WATER FLUSHING. TANK CAPACITY: 5 U.S. GALLONS. (18.9 LITERS)
- WASTE HOLDING TANK CAPACITY: 3.1 U.S. GALLONS. (11.7 LITERS)
- COMPACT, DURABLE, MAINTENANCE-FREE CONSTRUCTION OF A.B.S. INJECTION MOLDED PLASTIC.
- EASY REPLACEMENT OF ALL COMPONENTS



This is the newest concept in lightweight, easy to carry portable toilets. It's compact, efficient, easy to service and empty, — the ideal toilet for trailers, campers, boats, tents, wherever portable sanitation is required. No installation of water supply hookup. Occupies a minimum amount of space.

The upper half of the Tota-II has a built in fresh water supply tank, the contents of which are used to flush the toilet. The lower half is a sewage holding tank that is easily carried about like a suitcase. Two positive locking quick-release latches hold the two sections firmly together.

The Tota-II features a mechanical bowl trap that prevents leakage of liquids and odors. To open trap simply unscrew red nut and pull handle all the way out. To close trap, push handle all the way in and tighten nut. When using, the mechanical trap may be placed in the open position or left closed to provide a "wet bowl" like a household toilet.

SPECIFICATIONS

Weight: 15 lbs. (6.8KG)
Size: 16 $\frac{3}{4}$ " (425.5 mm) W (including latches)
x 13" (330.2 mm) H x 16 $\frac{3}{4}$ " (425.5 mm) D.

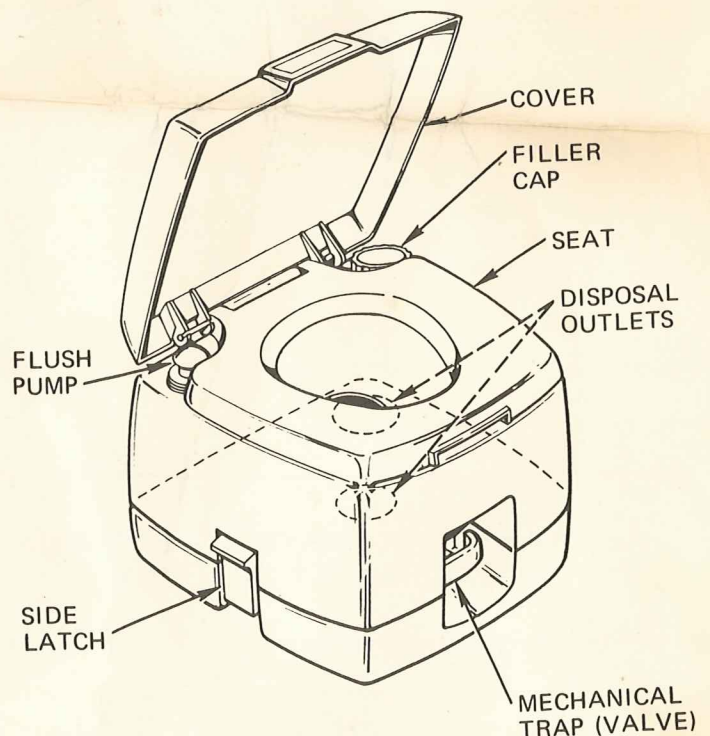

TOTA II™

OPERATING INSTRUCTIONS

TO USE

1. Open filler cap. Fill with water to 3" from top of opening. Do not pour toilet chemical in upper pour spout.

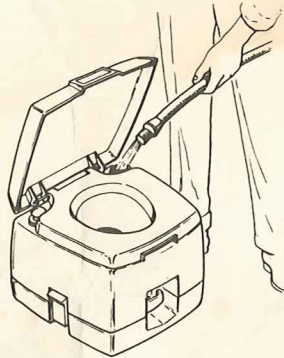

2. Unscrew red nut. Open valve. Pull handle all the way forward.

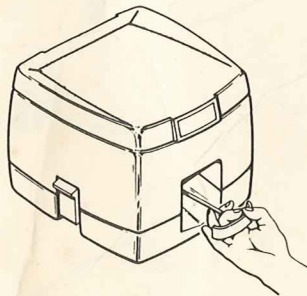

3. Add contents of one packet of Monochem® PTC™ Portable Toilet Chemical or Monochem T-5® through open valve. Flush once or twice by operating pump up and down. Close valve.

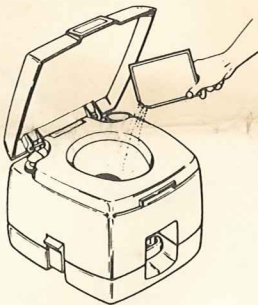

4. During use, valve may be placed in open position or left closed to provide "wet bowl" like a household toilet. After each use operate pump up and down to cleanse and rinse bowl.



TO EMPTY

Empty unit when you return home or when lower tank is filled to 1/2" below slide valve.

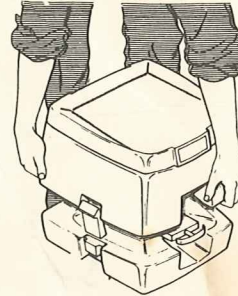

1. Be sure slide valve is closed and/or red nut is tightened. Release side latches and lift upper unit off.

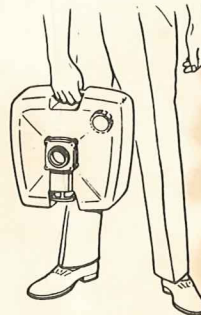

2. Lower unit may now be carried like a suitcase.

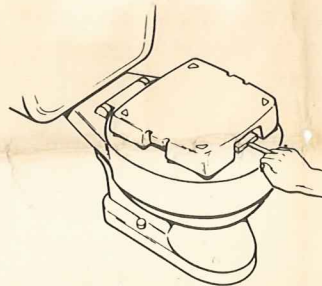

3. To empty through valve openings, place holding tank upside down over toilet bowl. Slowly pull trap handle all the way forward. Important: Pour spout can be utilized as an alternate method of discharge only when tank is less than 3/4 full.

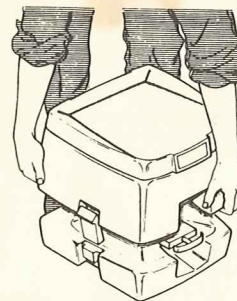

4. Place upper tank over lower tank. Align both tanks and engage latches. Tota II is ready for use. Note: No need to refill the upper tank after each servicing. It has enough capacity for two complete use cycles.

GENERAL MAINTENANCE

Periodic cleaning of the Tota II is recommended, just as it is for a household toilet. Fill holding tank with water. Add Monochem® Holding Tank Cleaner (see directions on container). If Monochem is not available, use one half cup of Vanish Bowl Cleaner crystals or cold water detergent. Allow solution to stand for not more than 30 minutes. Drain tank and flush thoroughly.

REPLACEMENT PARTS LIST

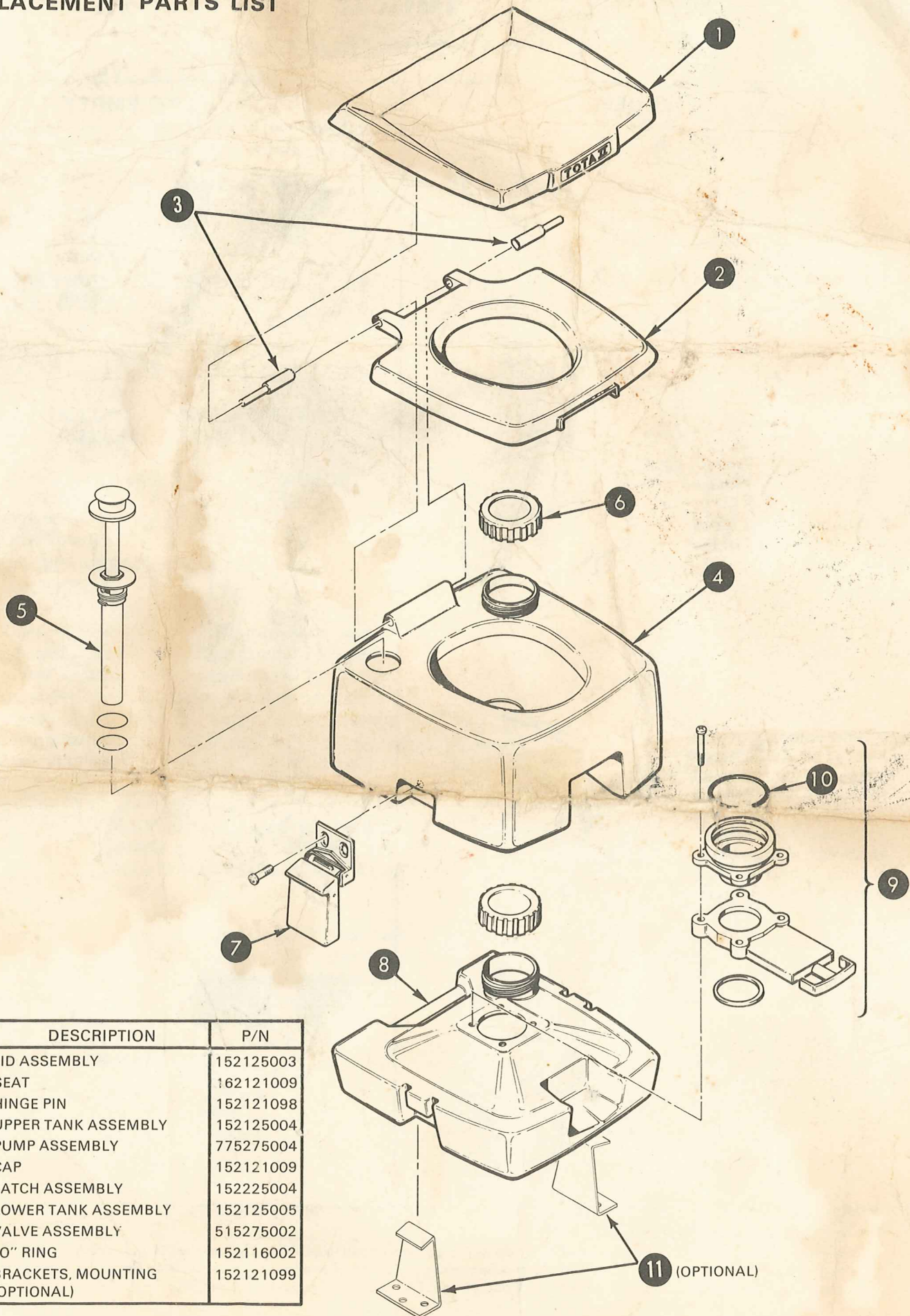

KEY	DESCRIPTION	P/N
1	LID ASSEMBLY	152125003
2	SEAT	162121009
3	HINGE PIN	152121098
4	UPPER TANK ASSEMBLY	152125004
5	PUMP ASSEMBLY	775275004
6	CAP	152121009
7	LATCH ASSEMBLY	152225004
8	LOWER TANK ASSEMBLY	152125005
9	VALVE ASSEMBLY	515275002
10	"O" RING	152116002
11	BRACKETS, MOUNTING (OPTIONAL)	152121099